

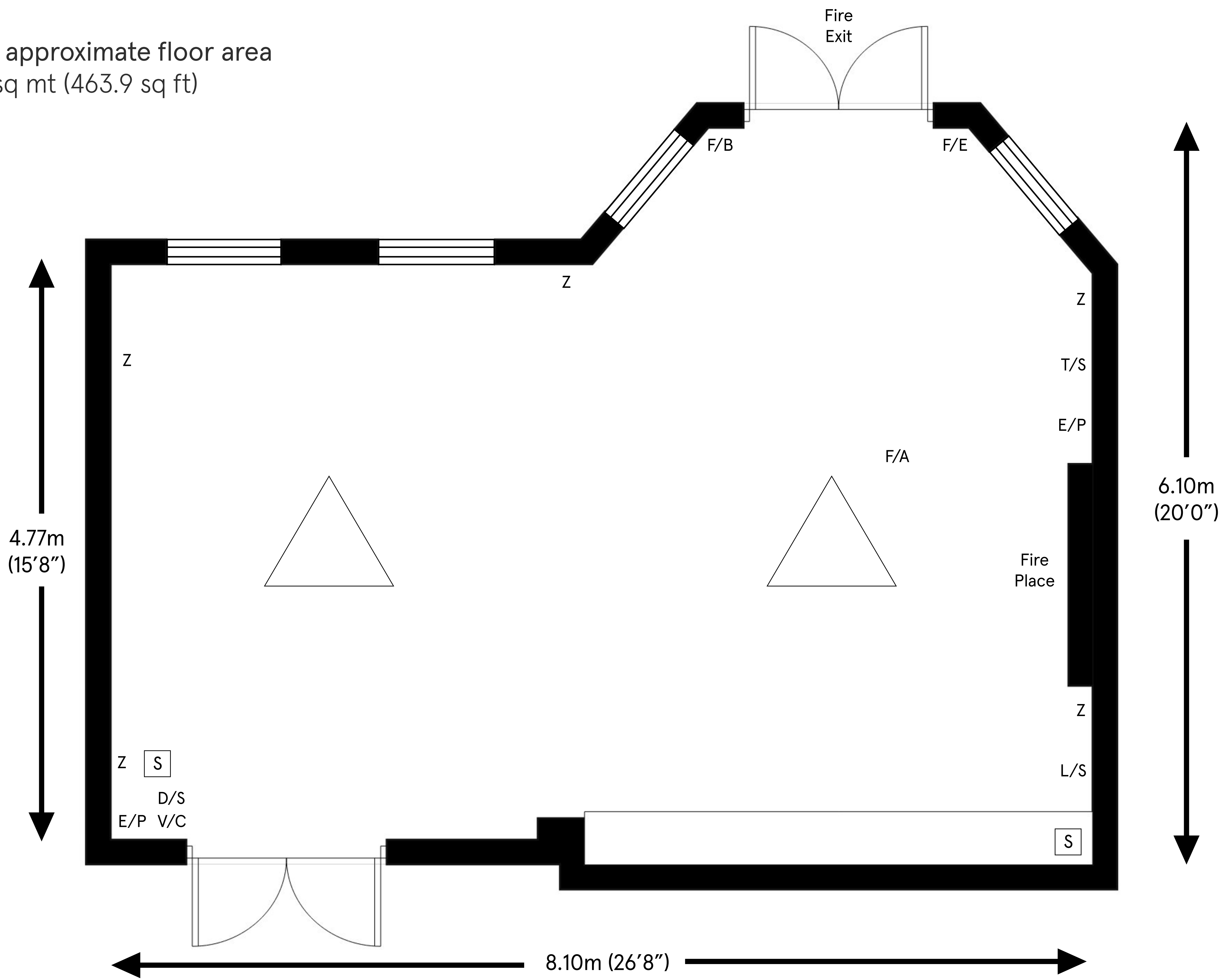

# Library

Ceiling height  
 Max 3.02m (9'11")  
 Min 2.84m (9'4")

Total approximate floor area  
 43.1 sq mt (463.9 sq ft)



- Key:
- Z 13 Amp Sockets
  - L/S Light switch
  - D/S Dimmer Switch
  - F/B Fire Alarm Button
  - F/A Fire Alarm
  - F/E Fire Extinguisher
  - E/P Ethernet Port
  - V/C Volume Control
  - [S] Speaker
  - △ Chandelier
  - T/S TV Socket

For room capacity please refer to the room configuration charts